

# Installation Manual for Pole Mount Adapter Model A-BK5

## (1) SAFE USE OF EQUIPMENT



This unit must be properly and securely mounted to supporting structure capable of sustaining the weight of the unit approx.5kg(11 lbs).

Max Wind Load: 50m/sec      Max Weight: 5kg(11 lbs)  
 Size of IP66 Dome Camera: Max Dia 200mm(7.9") x Max Height 200mm(7.9")  
 Size of IP66 Box Camera: Max 150mm(5.9") x 150mm(5.9") x 350mm(13.8")  
 Distance Between Mounting Bracket and Camera Window: 550mm(21.7")

## (2) ACCESSORIES

- ① SUS304 Belt 20mm(0.78") x 1500mm(59") x 2
- ② SUS304 5-16 U-Bolt x 2
- ③ SUS304 M4 x 20mm Screw(Phillips Button Head) x 8
- ④ SUS304 M4 Washer x 8
- ⑤ SUS304 M4 Lockwasher x 8

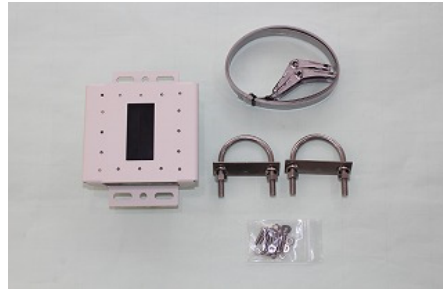

## (3) Compatibility of Mount Pattern

Mount Pattern	Shape	Direction
85.7 x 85.7mm	Square	-
46 x 83.5mm	Rectangular	Vertical & Horizontal
83.5mm	2 points	Vertical & Horizontal

## (4) INSTALLATION

For Small Pole  
 (Photo: 1 1/2"NPT)  
 Use **U-Bolt**



Tighten Hex Nut with **Adequate Torque** for each size of Pipe.

**Do not tighten it too strongly.**

(Stop it before the mount bends)

Be sure to use Lockwasher.



For Big Pole, Use **Belt**



Pull in Stainless Belt thru slot. Pay attention to the direction of cover and slot.



Wind up Stainless Belt by the **Adequate Torque**. (You can wind it up by moving cover right and left)

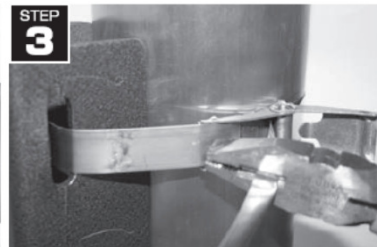

Press Stainless Belt vertically by pliers.



### WARNING

Too much torque may damage Stainless Belt and thus breaks it.

**Wind up Stainless Belt by Adequate Torque (Not too strong & Not too weak)**



Cut the center you pressed.

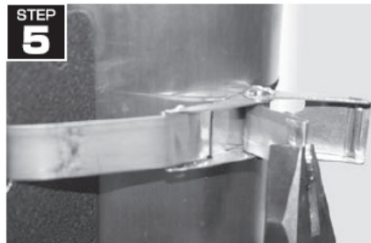

Bend the end of Stainless Belt so that it can be within cover.

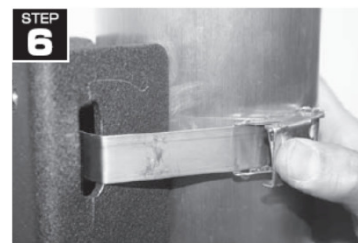

Close Cover.